

**Caution**

Always disconnect electrics before commencing any installation.

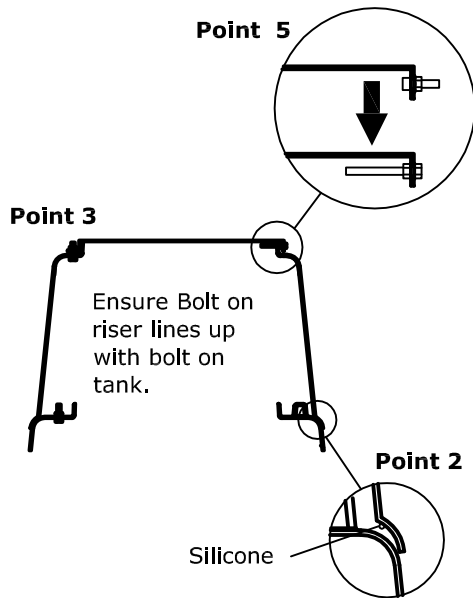
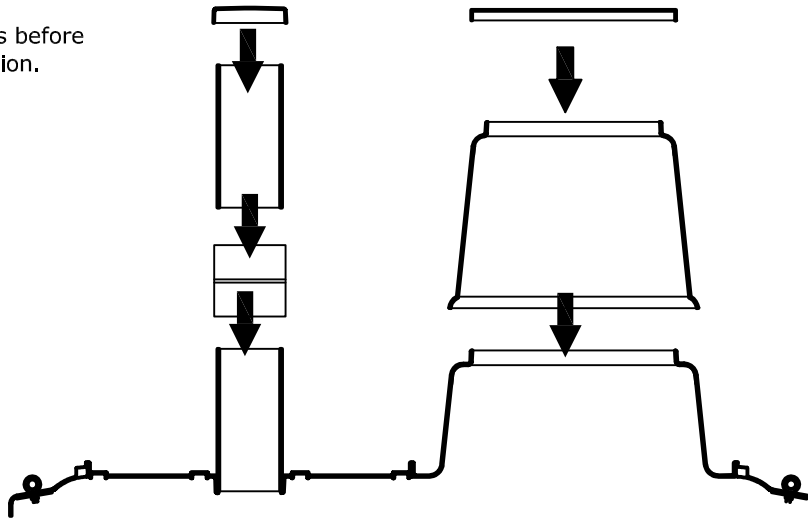

**Manhole Riser**

1. Take off access cover. Disconnect any electrics or pipework if necessary.
2. Apply a bead of silicone around the inside of the radius at the bottom of the riser.
3. Place riser over manhole, lining up the locking bolts, and push down.
4. Screw the riser to the manhole. One screw in each corner and 1 in the center of each side. 8 in total.
5. Replace the bolts in the access cover for the longer bolts supplied and reverse so they point inwards as shown.
6. Reconnect any electrics and pipework, if necessary. Extension pieces are supplied.
7. Slide access cover onto riser so the bolts extend into the holes on the top of the riser and lock the front to secure.

**Desludging Cover Riser**

- A. Take off desludging Cover
- B. Apply a bead of silicone around the inside of both sides the joiner to seal.
- C. Put joiner on to pipe already on tank.
- D. Put on extension piece of pipe.
- E. Apply another bead of silicone to the outside of the joiner to ensure water tight seal
- F. Place desludging cover onto pipe and secure as before.

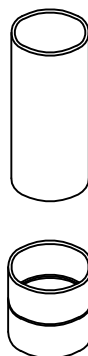

**Point 4**

